

# WALLTOPIA

## COMPANY OVERVIEW



# WHO WE ARE

---

## Walltopia is the world's leading climbing wall & active entertainment manufacturer.

Walltopia was born out of the shared passion for climbing and the business acumen of two close friends. Their journey began in 1998 in a small Bulgarian town, when Ivaylo Penchev and Metin Musov chose to shift their focus from personal climbing ambitions to establish a company that would ultimately revolutionize the indoor climbing industry.

Fast forward 25 years to today, Walltopia has grown into a thriving company with over 400 dedicated employees. We've proudly completed more than 2200 projects worldwide. Our sales offices are located in the USA and China, while our heart beats in Sofia, Bulgaria.

Building on our extensive experience in the climbing industry, we embarked on an exciting journey in 2012. Fueled by our passion for action sports and a desire to turn physical activity into a fun and purposeful endeavor accessible to everyone, regardless of their sports background, we ventured into a new product line: Active Entertainment.

This product line encompasses various offerings, all with a shared mission — to inspire people to lead an active lifestyle and enjoy quality time with friends and family in a way that's both enjoyable and meaningful.

**Climbing Walls** - rope and boulder walls for both indoor and outdoor use; speed walls, adjustable angle boards; training boards; kids climbing walls

**Fun Walls** - interactive climbing walls

**Ropes Course** - aerial adventure courses

**Caves** - artificial caving

**Rollglider** - aerial ride that combines the feel of zipline and rollercoaster

**Ninja Course** - obstacle courses inspired by the famous TV show

**Adventure Hub** - all of the above combined with other amusement attractions into one massive entertainment facility.

**Playgrounds** - elevating play to a whole new level

**Adventure Trail** - unharnessed exploration with the thrill of heights

**Cloud Climb** - unharnessed climbing maze

**Ziplines** - the ultimate adrenaline rush

**Tree Course** - ropes course with outstanding design.

**Slides** - the best way to go down

**Trampolines** - jump into the fun

**Net Maze** - combination of playground and maze



# LIFESPAN OF A PROJECT

DESIGN

ENGINEERING

PRODUCTION

LOGISTICS

INSTALLATION

MAINTENANCE

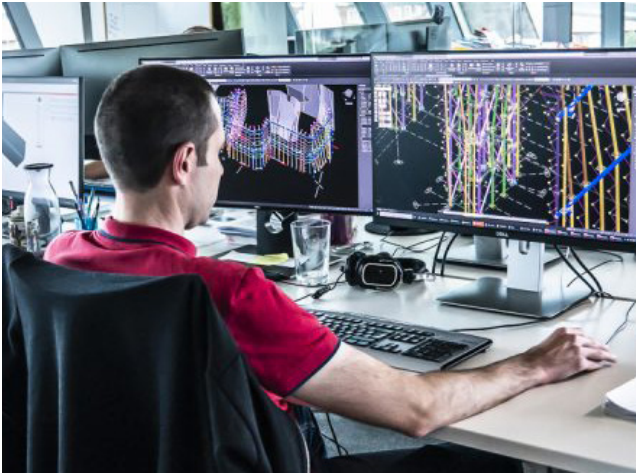

# IN DETAILS

## ARCHITECTURE & DESIGN DEPARTMENT

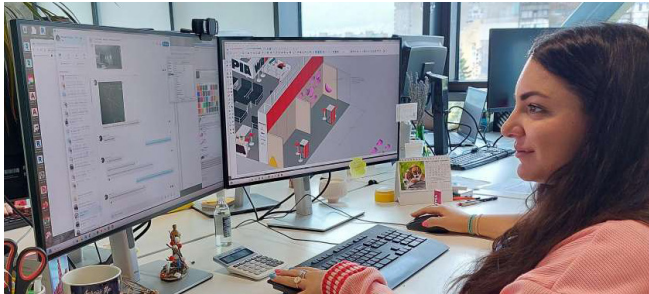

Our versatile team of architects and 3D artists is well-equipped to tackle any design challenge, ensuring we meet customer expectations regarding capacity, budget, target audience, and operational model. Whether it's small climbing walls or expansive gyms, single attractions or adventure hubs, we excel at finding the perfect layout and appearance for every project.

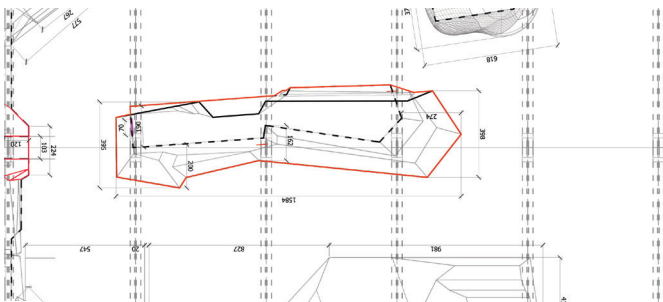

Our team of structural and mechanical engineers, drafters, and CNC programmers rigorously adhere to local regulations, guaranteeing precise calculations and accurate installation of climbing walls and entertainment attractions.

## PRODUCTION FACILITIES

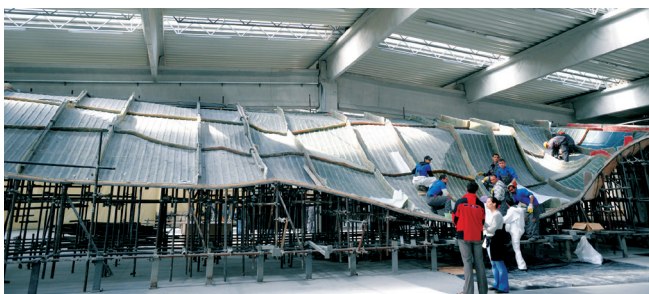

Our three production facilities, covering over 40,000 square meters (430,556 square feet), manufacture various components including steel, plywood, fiberglass panels, and electronics. We are committed to continuous innovation, development, and improving our production processes and services to set the industry standard.



### Iron shop:

- Capacity of 450 tons of steel per month
- Team of 150 people (incl. welders and locksmiths)

### Plywood panels production:

- Capacity of 1 550 400 sq.ft / 144 000 sq.m per year
- Team of 32 people
- Two 5-Axis CNC Machines
- Latest texturing & painting equipment;

### Fiberglass panels production:

- Capacity of 301 389 sq.ft / 28 000 sq.m per year
- Team of 50 people
- Highly qualified employees, including sculptors and art workers.

## PROJECT MANAGEMENT & INSTALLATION DEPARTMENT



Walltopia's project managers and technicians travel globally to professionally install climbing walls and attractions. They receive specialized training at Walltopia Academy, covering welding, working at heights, and operating mobile platforms. Each technician crew, led by a civil engineer from our headquarters, is supported by our maintenance and inspection team to ensure long-term product reliability.

# BRANDS AND ASSOCIATE COMPANIES

# WALLTOPIA



ACTIVE ENTERTAINMENT



ELEVATED PLAYGROUNDS

CAVES

NINJA COURSE

ADVENTURE HUB

ZIPLINES

ROPES COURSE

ADVENTURE TRAIL

NET MAZE

CLOUD CLIMB

TREE COURSE

TRAMPOLINES

SLIDES

# OUR WORK

---



# OUR WORK

---



# WALLTOPIA



OVER 2000 PROJECTS  
IN 80+ COUNTRIES ON 6 CONTINENTS

---

Founded in Bulgaria in 1998, Walltopia is a world leader in the Climbing and Adventure & Leisure industries. The company started out with the purpose of designing and manufacturing the most advanced climbing facilities in the world.

Our passion for science, technology and our obsession with excellence and safety, made us a leader and top expert in the Climbing and Active Entertainment industries.

We pride ourselves with our highly complex projects that always deliver expected results – starting with the design, moving on to the installation and finally – the certification.

Today we have the largest portfolio of classic and novel attractions that combine fun and entertainment with healthy doses of adrenaline for people of all ages. With sales offices in the USA, China and Head office in Sofia, Bulgaria and four production plants employing more than 400 people, to this day, we have produced over 2200 projects in 80+ countries and on 6 continents.

Our products are installed across adventure parks, amusement parks, shopping malls, gyms, recreational areas, ski resorts, schools & universities, hotels and more.

## LET'S TALK ABOUT YOUR PROJECT

Contact us at [sales@walltopia.com](mailto:sales@walltopia.com)  
or visit [walltopia.com](http://walltopia.com)