

# SAMPLE PROJECT 3

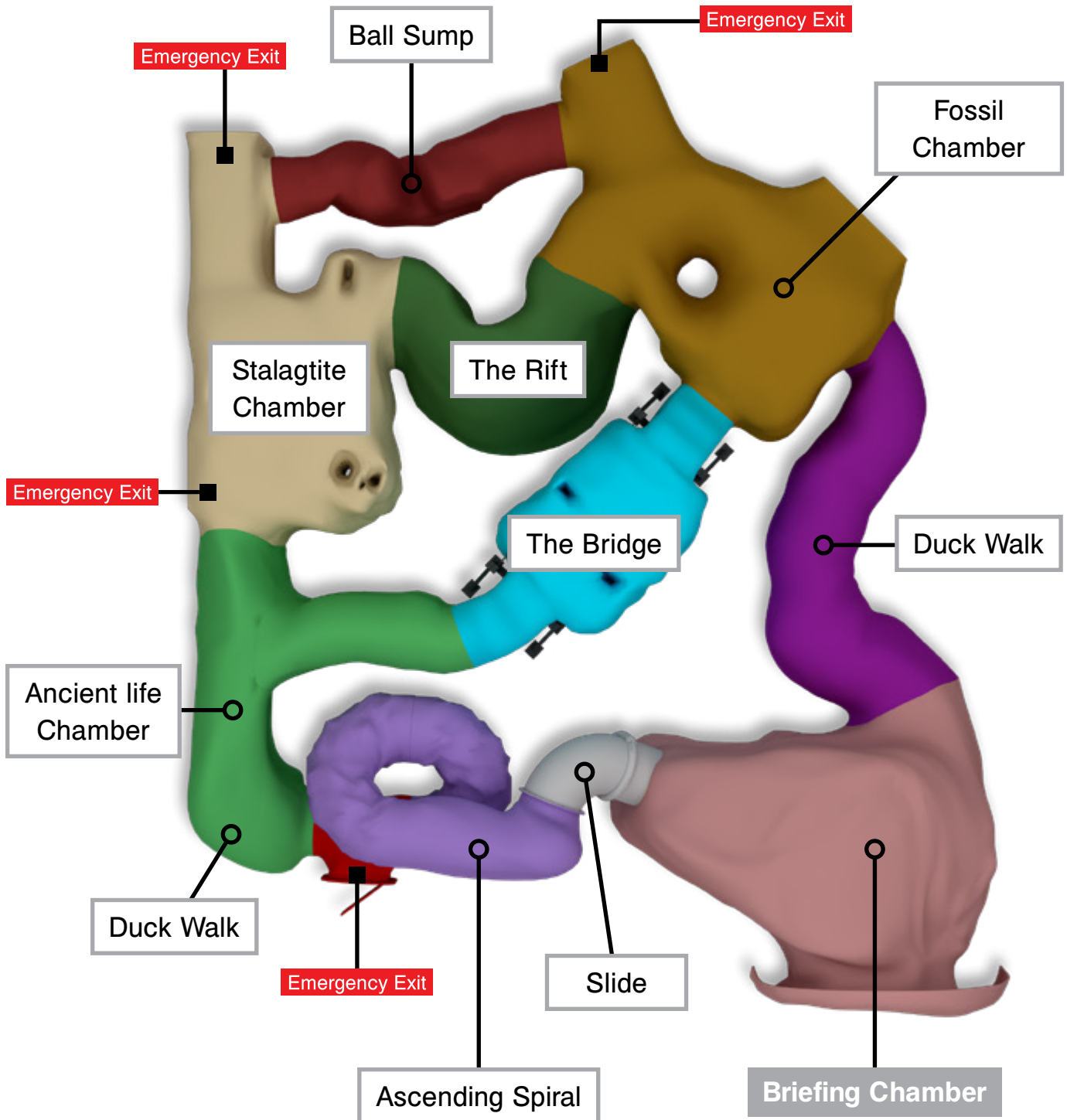

## Components

- Ventilation system
- LED lighting
- CCTV
- Sound system
- Emergency exits
- Gear (helmets, knee pads, torches)
- Ball sump
- Rubber floor
- Bridge

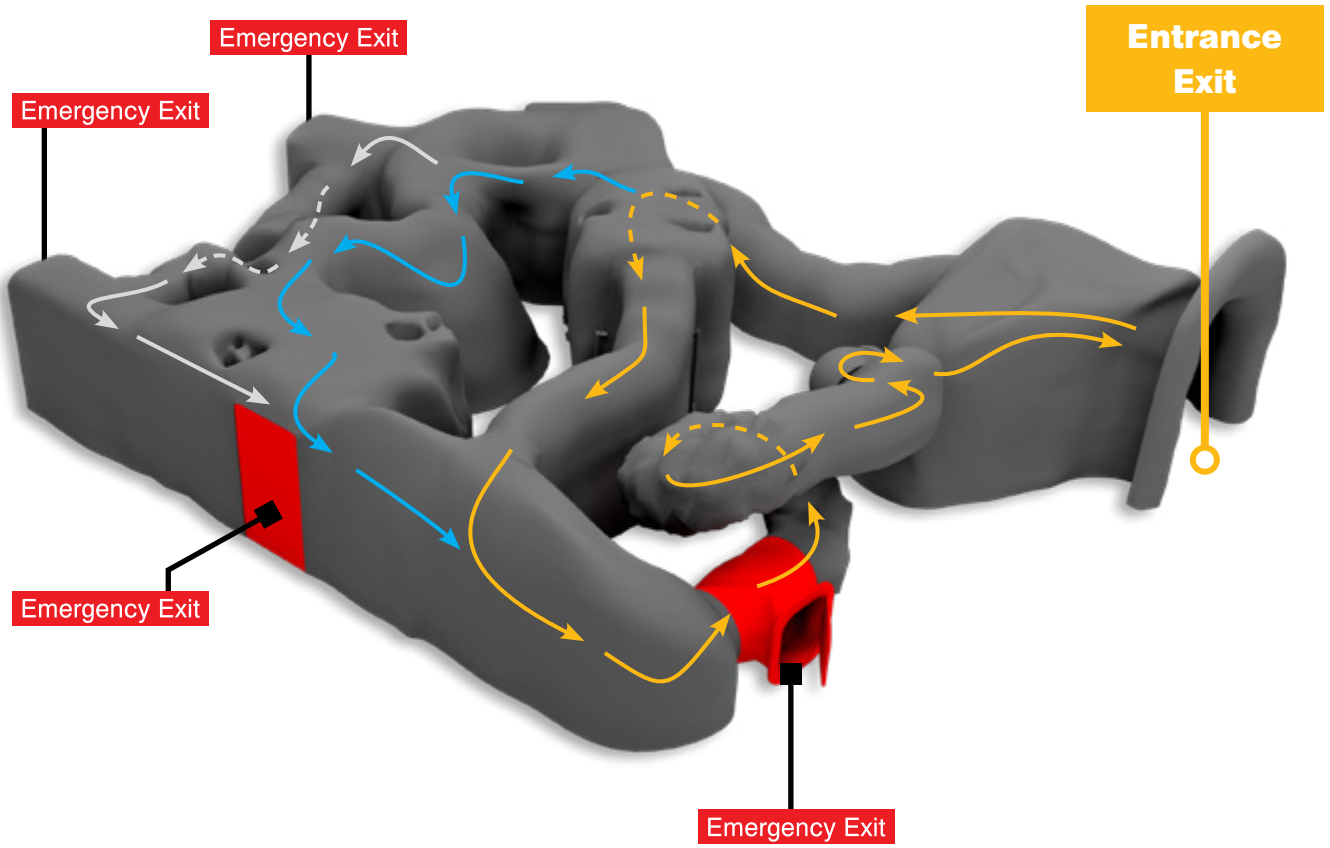

<b>Momentum Capacity</b>	21 people	
<b>Footprint</b>	136 m <sup>2</sup>	1,463.8 ft <sup>2</sup>
<b>Height</b>	3,5 m	11.4 ft
<b>Operational Length</b>	57 m	187 ft
<b>Routes</b>	2	
<b>Min. Operators Required</b>	2	
<b>GRP</b>	337m <sup>2</sup>	3,627.4 ft <sup>2</sup>